

# All Saints Winterton, Diocese of Lincoln, Grade 1 - Alterations and Extension.

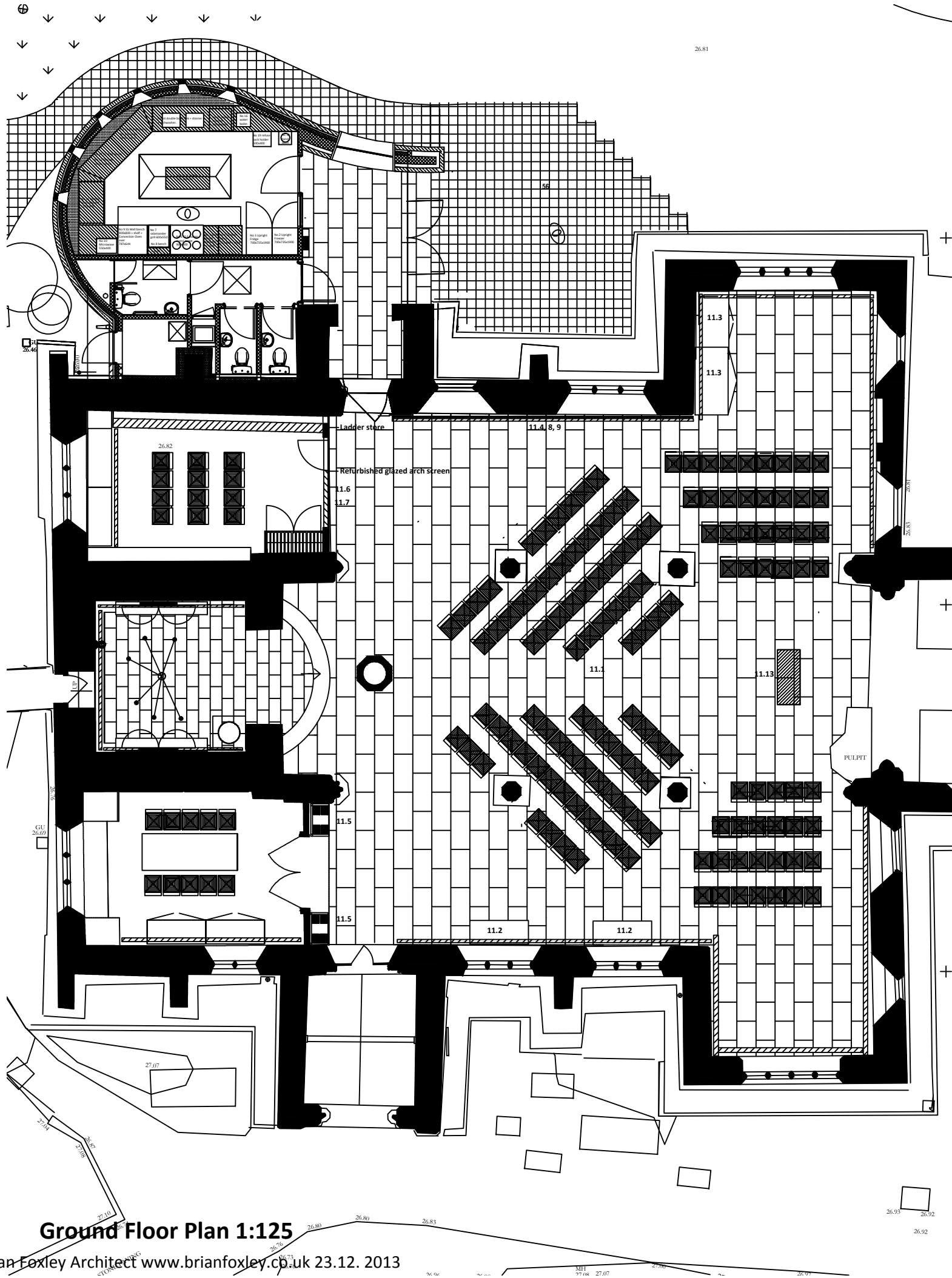

## NAVE + AISLES + TRANSEPTS

**1. PREPARATION**  
 ARCHAEOLOGIST WATCHING BRIEF FOR ALL INVESTIGATIONS AND EXCAVATIONS TO THE FLOOR

Carefully store in Chancel for future relocation.

- a. Medieval Font and Capital base
- b. Altar tables
- c. Framed photographs
- d. Rectors List
- e. War Memorial plaque.
- f. Freestanding grave cover.
- g. Digital Organ

Remove Pews and Pew Platforms for Employer disposal.

Remove gas radiant heaters + pipework  
 Remove C19 Font for burial  
 Remove C19 font base and stand for relocation elsewhere.

Carefully take up existing Ledger Stones and place in secure area.

Carefully take up C19 sandstone paving for re-use in church path.

## 2. FLOOR

ATTEND ON ARCHAEOLOGIST EXCAVATION OF SUB FLOOR TO FORMATION LEVEL

NB With existing voids below platforms and C19 disturbed ground following heating ducts the anticipated excavation depth of undisturbed ground is approx 75mm

Excavate below new Font location to install small soakaway and for burial of C19 Font.

Conservation consolidation to arcade bases.

Form new breathable heated solid floor comprising  
 35 thk Ancaster Weatherbed or Hard White paving, 450 w x varying lengths, honed finish, joints 4mm. Pointed in lime mortar.  
 on 15 lime mortar bedding  
 on 65 Glaister or Lime screed incorporating under floor heating pipework  
 on 150 NHL 5 Limecrete Slab on geotextile membrane wrapped with lower membrane.  
 on 200 thk Recycled Foamed Glass (RFG) insulating hardcore.  
 on geotextile membrane wrapped with upper membrane.  
 50mm evaporation zone from surface to subsoil, filled with clean stone 20-20mm to all perimeter junctions with historic walls and arcade piers.  
 Perimeter heating duct approx 200w x 175d with aluminum grill, flush to floor level

Form step down to Tower floor level of 150mm Ancaster Hard White stones 450 w x 1200 l with bullnosed nosing, 15mm DIA bronze coloured metal hazard studs set flush @ 150c/c.

Relocate Medieval Font to new location on cube block of Ancaster White stone with drainage + trap to soakaway below.

Time capsule to be buried beneath font.

Relocate Ledger stones to N Transept

## 3. WALLS

Carefully remove existing failed plaster under conservator supervision to identify any surviving wall paintings fragments

Replaster in 3 coat NHL 3.5 haired lime plaster.

Redecorate with either Limewash or quartz primer and fully breathable silica based paint depending on salt contamination of background.

Conservation repair to monuments to include 250mm margin of surrounding plasterwork.

Conservation repair to Niches.

Masonry repair to window tracery and reveals openings as identified in QIR.

Masonry repair and consolidation to South Transept Window masonry.

Form new full height timber stud partition between N Aisle and Heritage Room. Clad in gypsum plasterboard and finish in lime plaster. Form curved arch for relocation of Tower Screen. Form surround for ladder access door.

## 4. CEILING

Redecorate existing timberwork with 2ct matching woodstain.

## 5. DOORS

South Door C13  
 Conservation redecoration to medieval iron work.  
 Conservation repair to hinges and masonry stays.  
 Draughtproofing.

North Door C19  
 Conservation refurbishment to C19 wood door. Additional make up piece to bottom rail following removal of step.

HERITAGE ROOM DOOR  
 Reglaze former Tower Screen with clear bevelled cast glass. Refix to arch formed studwork partition.

LADDER ACCESS DOOR  
 Form access door painted Tulip wood within partition to lower RH corner.

**5. WINDOWS**  
 Masonry repairs as outlined in QIR  
 Conservator repair to South Transept South window stained glass.

**6. HEATING**  
 Underfloor heating wet system within glaister screed. manifolds housed in Oak cabinet furnishings  
 Location TBA

**7. LIGHTING**  
 Feature lighting to proposals by Graham McLusky inc chandelier lighting to Aisles and wall mountedup/down lighting to Nave Chancel.

**8. ELECTRICAL SERVICES**  
 Full S+F detection.

**9. SOUND SYSTEM**  
 New sound system as proposed

**10. POWER**  
 Power distribution as drawn, distributed via below slab containment ductwork to inset paved ss floor boxes as drawn.

## 11. FURNITURE AND FITTINGS

1. Oak chair/benches with sea grass seats as Treske of Thirsk
2. 2no Oak cabinet chair stores each 16no folding Oak chairs, seagrass seats on trolleys - to detail. Located in South Aisle.
3. 2no Oak cabinet table stores for 16no foldaway tables on trolleys saeting 128no - to detail. Located in North transept
4. Timeline (Interpretation) to North Arcade Wall - to detail.
5. 2no Oak Hymn Book cabinets either side of door to Parish roomto incorporate Heating Manifold unit and merchandise.
6. Interpretation screen and stand
7. Memorial day book and Oak stand
8. Refix Rectors List
9. Refix War Memorial plaque.
10. Relocate North Transept Altar table.
11. Relocate Parish Bier + Pal to N Transept.
12. Relocate digital organ to S Transept.
13. Form Nave Alter of ex Oak Altar top on new Oak base.

Ground Floor Plan 1:125